

QUICK START GUIDE

Read this manual carefully and save it for future reference.

Disclaimer: The products, accessories, user interfaces, etc. illustrated in this guide are intended for reference only. Due to product updates, the actual product and the illustrations in this guide may vary.

GET BETTER SECURITY WITH Cam Plus

Record Full-Length Videos
Get unlimited full-length video recordings.

Smart AI Detection
Detect people, packages, vehicles, and more.

Back-to-Back Event Recording
Capture everything without 5-minute gaps.

Exclusive Discounts
Get exclusive discounts on Wyze products.

Subscribe or learn more at my.wyze.com.

IN THE BOX

- | | |
|---------------------------------|----------------------------|
| Wyze Battery Video Doorbell × 1 | USB-C Charging Cable × 1 |
| Back Plate × 1 | Extension Wires × 2 |
| Corner Kit × 1 | Wall Anchors × 3 |
| Wire Nuts × 3 | Doorbell Detaching Pin × 1 |
| Long Screws × 3 | Jump Wire × 1 |
| Short Screws × 5 | Quick Start Guide × 1 |

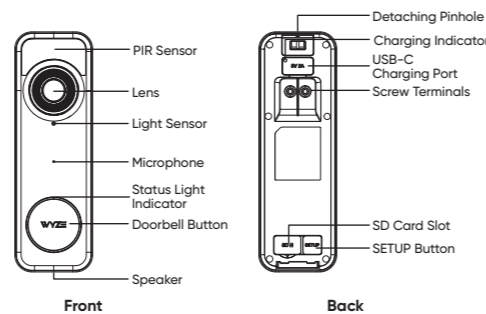

SD CARD INSTALLATION

If you want to use a MicroSD card in your doorbell, install it before setting up the doorbell.

SD card is not included.

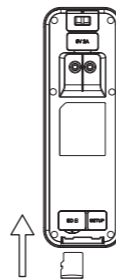

DOWNLOAD

Download the Wyze app and sign in or create an account.



Apple logo and App Store are trademarks of Apple Inc., registered in the U.S. and other countries and regions. Google Assistant, Google Home, Google Play, and the Google Play logo are trademarks of Google LLC.

DOORBELL SETUP

- Press the SETUP button on the back of the doorbell to wake it up.
- In the Wyze app, tap the + plus sign, on the Add menu, tap **Device > Cameras > Video Doorbells > Wyze Battery Video Doorbell**. Follow the in-app instructions to finish setup.

Note: If the device doesn't wake up or say "Ready to connect," press and hold the SETUP button for 20 seconds to restart. If still no power, use the included cable to charge the doorbell before continuing.

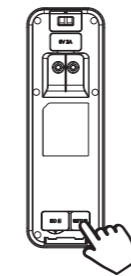

INSTALLATION

- You'll need a Phillips #0 screwdriver for installation.
- To screw the doorbell to the wall, a 5/16 inch drill bit is required.

Option A: Battery Mode

To install the doorbell using battery power, simply mount the doorbell at your preferred viewing angle.

Straight-Ahead View
Installed with vertical back plate only



Install the vertical back plate to the wall with long screws and anchors.

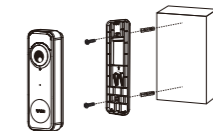

Angled View
Installed with corner kit + vertical back plate

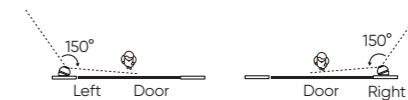

Install the corner kit to the wall with long screws and wall anchors. Then, use the short screws to install the vertical back plate to the corner kit.

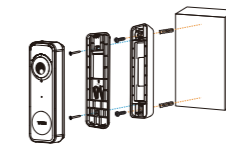

You are all set.

Option B: Wired Installation

Disconnect the AC power supply before installing the doorbell.

Step 1: Install the doorbell using AC wiring

Mount the doorbell at your preferred viewing angle.

Straight-Ahead View
Installed with vertical back plate only.

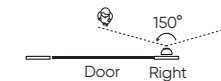

Install the vertical back plate to the wall with long screws and anchors, routing the wires through the back plate.

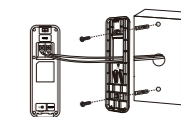

Angled View
Installed with corner kit + vertical back plate

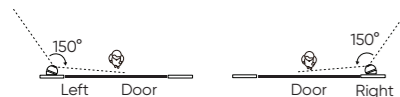

Install the corner kit to the wall with long screws and anchors. Then use the short screws to install the vertical back plate to the corner kit.

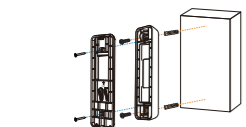

Route the wires through, then connect directly to the doorbell.

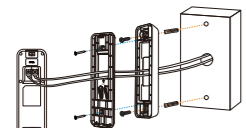

If needed: Route the wires, then use an extension wire to connect to the doorbell.

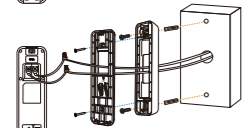

Step 2: Bypass the existing chime

⚠️ Note: If not followed, the chime box may produce unexpected sounds.

Shut off power to your chime box at the breaker.

If your chime box has three wires, please follow the wiring instructions below:

Connect the "Front" and "Trans" terminals with the jump wire if your doorbell is installed at the front door.

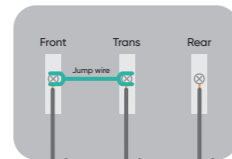

Connect the "Rear" and "Trans" terminals with the jump wire if your doorbell is installed at the rear door.

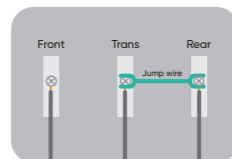

If your chime box has more than three terminals, please follow the in-app installation instructions for 4 or more wires.

You are all set.

USE WITHOUT CHIME

To use without a chime, you can set up notifications and integrations in the Wyze app.

USE WI-FI CHIME

To use without wiring, a Wyze Universal Wi-Fi Chime (not included) is an option.

Please scan the QR code to purchase a Wyze Universal Wi-Fi Chime.



Scan to purchase

USE EXISTING CHIME

To use your existing chime, a Wyze Chime Controller (not included) is required.

Please scan the QR code below to purchase the Wyze Chime Controller.



Scan to purchase

To access installation instructions, please scan the QR code below.



Scan to install

DOORBELL LIGHT INDICATORS DURING INSTALLATION

- Solid red light**
The doorbell is powered on and initializing
- Flashing red light**
The doorbell is ready to connect
- Flashing red and blue lights**
Connection is in progress
- Solid blue light**
The doorbell is connected

DOORBELL LIGHT INDICATORS AFTER SETUP

- Solid blue light for 6s (Battery Power)**
Live stream is being viewed
- Solid red light for 6s (Battery Power)**
Live stream is being viewed, but battery is low
- Flashing blue light**
Firmware is being updated
- Solid blue light turns off after 6s (Battery Power)**
Firmware upgraded successfully
- Pulsing blue light (Battery Power)**
Ring the doorbell or doorbell is triggered by motion
- Solid blue light (AC Power)**
The device is working properly and no operations are running

INDICATORS DURING CHARGING

- Solid red light**
The doorbell is charging
- Solid blue light**
The doorbell charging is complete

How to attach and remove the doorbell from the back plate?

Make sure the doorbell is turned on. Align the bottom, before securing onto the back plate.

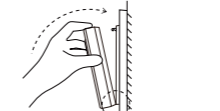

Hold the device with one hand. Then insert the Doorbell Detaching Pin into the hole at the top to remove.

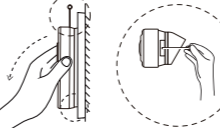

FCC WARNING

This device complies with Part 15 of the FCC Rules. Operation is subject to the following two conditions: (1) this device may not cause harmful interference, and (2) this device must accept any interference received, including interference that may cause undesired operation. Note: This equipment has been tested and found to comply with the limits for a Class B digital device, pursuant to Part 15 of the FCC Rules. These limits are designed to provide reasonable protection

against harmful interference in a residential installation. This equipment generates, uses and can radiate radio frequency energy and, if not installed and used in accordance with the instructions, may cause harmful interference to radio communications. However, there is no guarantee that interference will not occur in a particular installation. If this equipment does cause harmful interference to radio or television reception, which can be determined by turning the equipment off and on, the user is encouraged to try to correct the interference by one or more of the following measures:

- Reorient or relocate the receiving antenna.
- Increase the separation between the equipment and receiver.
- Connect the equipment into an outlet on a circuit different from that to which the receiver is connected.
- Consult the dealer or an experienced radio/TV technician for help.

Caution: Changes or modifications not expressly approved by the party responsible for compliance could void the user's authority to operate the equipment.

FCC RADIATION EXPOSURE STATEMENT

This equipment complies with FCC radiation exposure limits set forth for an uncontrolled environment. This equipment should be installed and operated with minimum distance of 20 cm between the radiator and your body.

ISED RSS WARNING

This device contains licence-exempt transmitter(s)/receiver(s) that comply with Innovation, Science and Economic Development Canada's licence-exempt RSS(s). Operation is subject to the following two conditions: (1) This device may not cause interference. (2) This device must accept any interference, including interference that may cause undesired operation of the device.

ISED RADIATION EXPOSURE STATEMENT

This equipment complies with IC RSS-102 radiation exposure limits set forth for an uncontrolled environment. This equipment should be installed and operated with minimum distance of 20 cm between the radiator and your body.

- the device for operation in the band 2412.0-2472.0 MHz is only for indoor use to reduce the potential for harmful interference to co-channel mobile satellite systems;
- the maximum antenna gain permitted for devices in the band 62.09 (17.93) MW (dbm) shall comply with the e.i.r.p. limits specified for point-to-point and non point-to-point operation as appropriate.

Supplier's Declaration of Conformity Unique Identifier
Trade Name: WYZE
Product Name: Wyze Battery Video Doorbell
Model No.: MR_BVD
Responsible Party - U.S. Contact Information
US Company Name: Wyze Labs, Inc.
Address: 8815 122nd Ave NE, Suite #201, Kirkland WA 98033
Telephone number or internet contact information:
1-844-999-3226 or www.wyze.com/pages/contact-us

Wyze and Wyze Battery Video Doorbell are trademarks of Wyze Labs, Inc.

CAUTION

Risk of fire or explosion if the battery is replaced by an incorrect type. Replacement of a battery with an incorrect type that can defeat a safeguard (for example, in the case of some lithium battery types); Disposal of a battery into fire or a hot oven, or mechanically crushing or cutting of a battery, that can result in an explosion; Leaving a battery in an extremely high temperature surrounding environment that can result in an explosion or the leakage of flammable liquid or gas. A battery subjected to extremely low air pressure that may result in an explosion or the leakage of flammable liquid or gas.

WARRANTY INFORMATION

Your Wyze product is covered by a one-year limited warranty. You can view the limited warranty terms at <https://wyze.com/return-warranty-policy> or request a copy by contacting Wyze at +1 (206) 339-9646.

NEED HELP?

Contact our Support Team:
<https://wyze.com/support>

Join the Community:
<https://wyze.com/community>



Scan the QR code to learn more