

品牌

2021.4.22
V1.0 首次创建

QUICK START GUIDE

IN THE BOX

- Wyze Cam x1
- Wyze Cam Lamp Socket x1
- USB Cable x1
- USB Cable Clip x3
- Wall Plate x1
- Mounting Tape x1
- Screws x6
- Wall Anchors x6
- Quick Start Guide x1

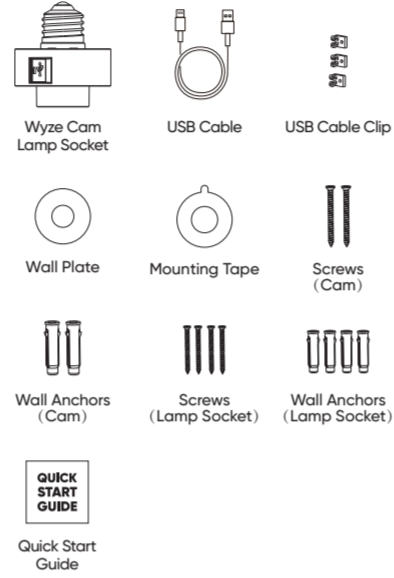
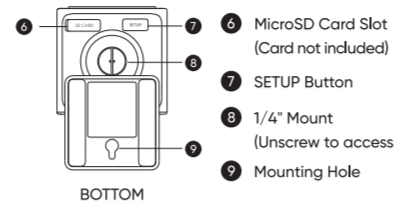
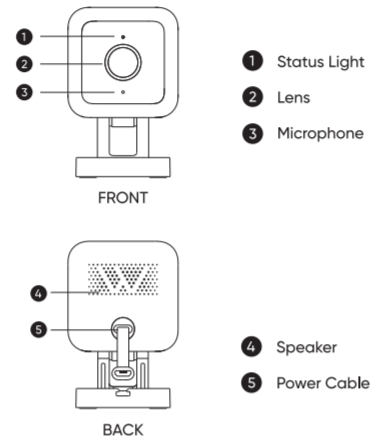

SETUP

Download the Wyze app and sign in or create an account.



Connect the camera to a power outlet and wait for 20 seconds or until the status light flashes red.

Press the SETUP button for 3 seconds or until there is a voice prompt.

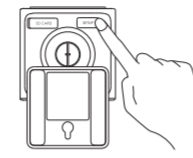

Follow the instructions in the Wyze app to finish setup.

LIGHT INDICATORS DURING INSTALLATION

- Solid red light**
The device is powered on and initializing
- Flashing red light**
The device is ready to connect
- Flashing red & blue lights**
Connection is in progress
- Flashing blue light**
The device is connected and finishing setup
- Solid blue light**
The device is working properly

LIGHT INDICATORS AFTER SETUP

- Solid red light**
Live stream is being viewed or a recording is in progress
- Quickly flashing red light**
Siren is in use
- Solid blue light**
The device is working properly and no operations are running (edited)

INSTALLATION

First open the dust cover, and then plug in the USB cable.

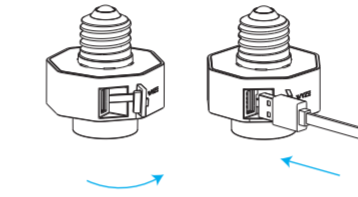

Please cut off the power before installing the bulb socket, (reminder: take out the light source in the lamp), then screw the smart lamp holder into the E26 lamp holder in the lamp, and arrange the USB cable to the proper position.

WARNING: MAKE SURE THE POWER OFF DURING INSTALLATION!

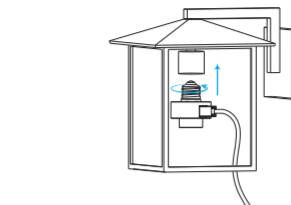

Screw the light source into the E26 interface of the smart lamp holder (reminder: only the light source with power ≤ 30W can be installed).

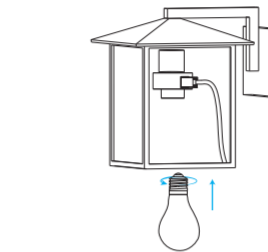

First tear off the glue on the back of the USB cable clip, stick it to the selected position, and then fix it with screws. Tip: The USB cable clip can be fixed by sticking or screwing.

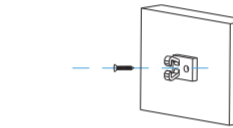

Insert the micro USB cable into the sleeve of the power adapter and make sure it is connected securely.

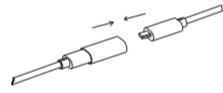

Arrange the USB cable in the USB cable clip.

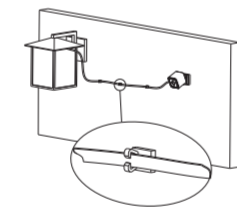

DEVICE NETWORKING OPERATION

- The distance between the lamp sockets installed by the user is less than or equal to 82 feet.
- After the installation is complete, the user will power on the lamp sockets at the same time within 30 seconds, and the lamp sockets will be grouped into a network by themselves.
- Use WYZE app control.

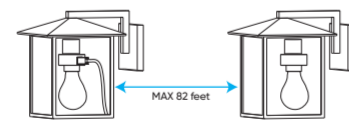

PRODUCT FUNCTION

- E26 output lamp port.
- Multiple smart lamp holders are installed in the range of 25M, and they will be automatically networked.
- Has a USB output interface.
- Can be used with Wyze cam v3.
- When connected with Wyze cam v3, the ON/OFF function can be set through the wyze app.
- AUTO option function: 1. Always 2. Motion is detected by camera. Always: the smart light will turn on automatically after sunset. Motion is detected by camera: When the ambient brightness is too low, the function of identifying moving objects through the camera can realize that people turn on the lights and turn off the lights when people walk. After multiple smart lamp holders are networked, they can be connected to the switch function.

BASIC PARAMETERS

Lamp holder model: E26
 Power input: AC 110V-125V/60HZ
 USB output voltage: DC 5V/1A MAX 5W USB1.1
 Lamp head output: AC 110V-125V/60HZ
 Lamp holder load power: MAX 30W
 Wireless characteristics: BLE/2.4GHz

IMPORTANT:

- This product is suitable for working temperature -4°F ~120°F (-20°C ~50°C).
- When installing, please make sure to cut off the power and do not touch the metal objects of the lamp.

- Before using the product, please confirm whether it is the working voltage of the product.
- This product has not been tested for waterproofing. Please install it in a waterproof fixture for outdoor use.
- The installation must be replaced and repaired by professionals.

FCC WARNING:

Any changes or modifications not expressly approved by the party responsible for compliance could void the user's authority to operate the equipment.
 This device complies with part 15 of the FCC Rules. Operation is subject to the following two conditions: (1) This device may not cause harmful interference, and (2) this device must accept any interference received, including interference that may cause undesired operation.

FCC RADIATION EXPOSURE STATEMENT:

This equipment complies with FCC radiation exposure limits set forth for an uncontrolled environment. This equipment should be installed and operated with minimum distance 20 cm between the radiator and your body. This transmitter must not be co-located or operating in conjunction with any other antenna or transmitter.

ISEDIC RSS WARNING:

This device complies with ISEDIC licence-exempt RSS standard(s). Operation is subject to the following two conditions: (1) This device may not cause interference, and (2) this device must accept any interference, including interference that may cause undesired operation of the device.

Le présent appareil est conforme aux CNR d'ISEDIC applicables aux appareils radio exempts de licence.
 L'exploitation est autorisée aux deux conditions suivantes:
 (1) l'appareil ne doit pas produire d'interférence, et
 (2) l'appareil doit accepter toute interférence radioélectrique subi, même si l'interférence est susceptible d'en compromettre le fonctionnement.

ISEDIC RADIATION EXPOSURE STATEMENT:

This equipment complies with ISEDIC RF radiation exposure limits set forth for an uncontrolled environment. This transmitter must not be co-located or operating in conjunction with any other antenna or transmitter.
 This equipment should be installed and operated with a minimum distance 20 cm between the radiator and your body.

Cet appareil est conforme aux limites d'exposition de rayonnement RF ISEDIC établies pour un environnement non contrôlé.
 Cet émetteur ne doit pas être co-implanté ou fonctionner en conjonction avec toute autre antenne ou transmetteur.
 Cet équipement doit être installé et utilisé avec une distance minimale de 20 cm entre le radiateur & votre corps.
 Any changes or modifications not expressly approved by the party responsible for compliance could void the user's authority to operate the equipment.
 Tous changements ou modifications non expressément approuvés par la partie responsable de la conformité peut annuler l'autorité de l'utilisateur à opérer l'équipement.

NEED HELP?

Contact our Support Team:
<https://wyze.com/support>
 Join our Community:
<https://wyze.com/community>



Scan the QR code to learn more

User Manual Version: V1.0

Scale 1:1 Unit:mm

型号: WYZELS1C1
 规格: WYZELS1C1-KSZP01 V1.0

产品名 ▶ Wyze Lamp Socket with v3

印刷颜色 ▶ CMYK

物料材质 ▶ 105g无光铜

样品

设计于 ▶ 于树媛

成品尺寸 ▶ 60*120mm

特种工艺 ▶

样品数量 ▶